

4K H.265 Pro NVR 8000 Series

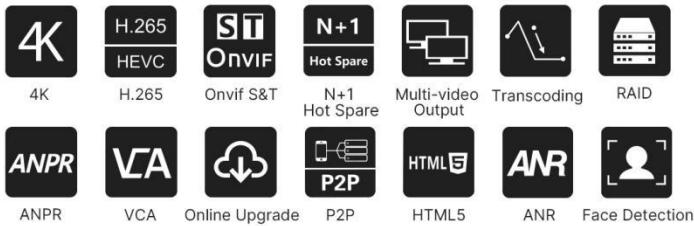

DATASHEET



KEY FEATURES

- ▶ 32/64-CH Network Video Input (Up to 32/64 channel IP cameras can be connected.)
- ▶ H.265⁺ (H.265⁺ allows to cut down 70%~80% bandwidth while ensuring the high quality of images compared with H.264.)
- ▶ HTML5 Streaming Ready (Support previewing the video via all major browsers without plug-in when Video Codec is set to H.265.)
- ▶ Transcoding (Transcoding guarantees fluid video experience by reducing the stream data via lowering resolution, bit rate, or frame rate.)
- ▶ Auto Backup (The latest 24 hours' video will be automatically backed up to USB Port Devices/NAS/eSATA after setting up the backup.)
- ▶ Versatile Interfaces (A whole array of ports provides all necessary features for effective surveillance.)

Power Decoding Capacity & Flexible Storage Options

- The 4K NVR is equipped with solid 4K decoding and display capabilities and maximum supports simultaneous viewing of 16*1080P or 32*720P network cameras.
- Providing flexible storage options including HDD, eSATA and NAS to address the needs for versatile storage.

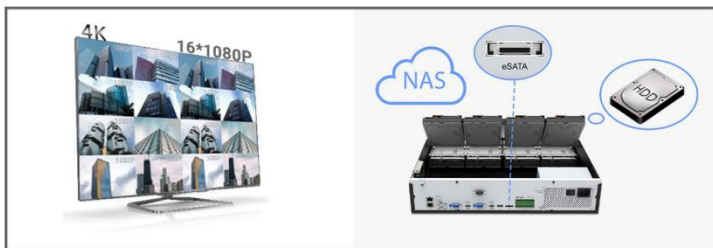

AI Video Analytics & POS Integration

- All-in-one to Manage AI & ANPR: VCA Function focus on human and vehicle detection. People Counting provides high-accuracy data and statistic reports. Face Detection function supports attribute recognition. Enterprise ANPR Management makes it easy to monitor traffic.
- POS machine information can be transferred to and displayed on the NVR.

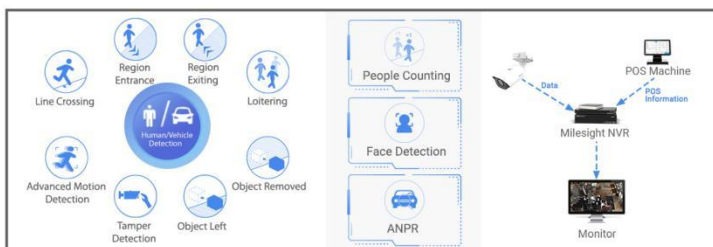

Reliability and Usability

- RAID improves the disk reliability to ensure the recording security.
- ANR can store video data on the camera storage card when network between IPC and NVR is disconnected and retransfer the recorded video to NVR after network recovers.
- N+1 Hot Spare can keep the system working on and ensure the data integrity and reliability.

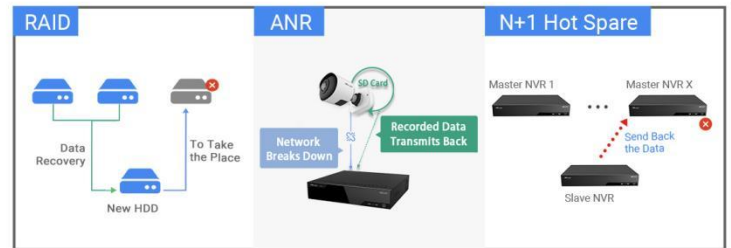

Flexible Structure Options

- Multi-video Output in two ways: Independent Outputs and Synchronous Outputs
- Dual network ports provide three network working modes for more independence, and higher throughput and stability according to the specific applications and needs.

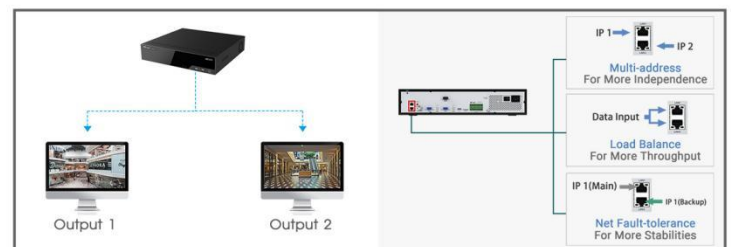

4K H.265 Pro NVR 8000 Series



| Model | | | MS-N8032-UH | MS-N8064-UH |
|-------------------------|----------------------|-----------|---|---|
| Video/Audio Input | Network Video Input | | 32-CH | |
| | Bandwidth | Incoming | 256Mbps or 200Mbps(when RAID is enabled) | 320Mbps or 200Mbps(when RAID is enabled) |
| | | Outgoing | 256Mbps or 200Mbps(when RAID is enabled) | 256Mbps or 200Mbps(when RAID is enabled) |
| Video/Audio Output | HDMI Output | | 2-CH, Resolution: 3840x2160/60Hz(HDMI1 Only), 3840x2160/30Hz(HDMI1 Only), 1920x1080/60Hz, 1920x1080/50Hz, 1280x1024/60Hz,1280x720/60Hz, 1024x768/60Hz HDMI Supports Audio Output | |
| | VGA Output | | 2-CH, Resolution: 1920x1080/60Hz, 1920x1080/50Hz, 1280x1024/60Hz, 1280x720/60Hz, 1024x768/60Hz | |
| | Dual Stream | | Support | |
| | Recording Resolution | | 12MP/8MP/6MP/5MP/4MP/3MP/1080P/UXGA/720P/D1/VGA/CIF/QCIF | |
| | Synchronous Playback | | 4*(30fps @8MP), 5*(30fps @6MP), 6*(30fps @5MP), 8*(30fps @4MP), 10*(30fps@3MP), 16*(30fps@1080P), 32*(30fps@720P) | 4*(30fps @8MP), 5*(30fps @6MP), 6*(30fps @5MP), 8*(30fps @4MP), 10*(30fps@3MP), 16*(30fps@1080P), 32*(30fps@720P), 64*(30fps @D1) |
| Video/Audio Compression | Video Compression | | H.265*/H.265(HEVC)/H.264*/H.264 | |
| | Audio Compression | | G.711/AAC/G.722/G.726 | |
| | Sample Rate | | 8KHz/16KHz | |
| Storage | SATA | | 8*SATA HDD (3.5") | |
| | eSATA | | 1*eSATA | |
| | Capacity | | Up to 10TB capacity for each HDD | |
| Disk Array | Array Type | | RAID0, RAID1, RAID5, RAID6, RAID10 | |
| Recording Management | Recording Type | | Continuous, Event (Motion Detection, Alarm, VCA, Smart Analysis) | |
| | Snapshot Type | | Continuous, Event (Motion Detection, Alarm, VCA, Smart Analysis) | |
| | Playback Type | | General Playback, Event Playback, Tag Playback, Split Playback, Picture Playback | |
| Backup | Backup | | Video Backup, Image Backup | |
| Network | Protocol | | IPv4/IPv6, TCP, UDP, RTP, RTSP, RTCP, HTTP, HTTPS, DNS, DDNS, DHCP, NTP, SNTP, SMTP, SNMP, UPnP, NFS | |
| External Interface | Network Interface | | 2*RJ45 10/100/1000Mbps | |
| | Serial Interface | | 1*RS-485 Series Port for PTZ | 1*RS-232 Series Port for Console |
| | | | 1*RS-485 Series Port for Keyboard | |
| | USB Interface | | 1*USB 3.0; 2*USB 2.0 | |
| | Audio Input/Output | | 1*RCA/2*RCA | |
| | Alarm Input/Output | | 16-CH/4-CH | |
| General | Compatibility | | ONVIF, API | |
| | Advanced Function | | ANR, N+1 Hot Spare | |
| | ANPR | | Support | |
| | Video Analysis | | Region Entrance, Region Exiting, Advanced Motion Detection, Tamper Detection, Line Crossing, Loitering, Human Detection, People Counting, Object Left, Object Removed | |
| | Keyboard Control | | Milesight Keyboard (MS-K01) | |
| | Power Supply | | AC 100V~240V 50Hz~60Hz | |
| | Consumption | | ≤35W(Without HDD) | |
| | Working Conditions | | Temperature: -10℃~55℃/Humidity: 10%~90% | |
| | Dimensions | | Rack Mountable Chassis (2.0U Standard) 440mm(W)X420mm(D)X88.2mm(H) | |
| | Weight | | 6.0Kg | |
| Warranty | | 3/5 Years | | |

4K H.265 Pro NVR 8000 Series



Interfaces

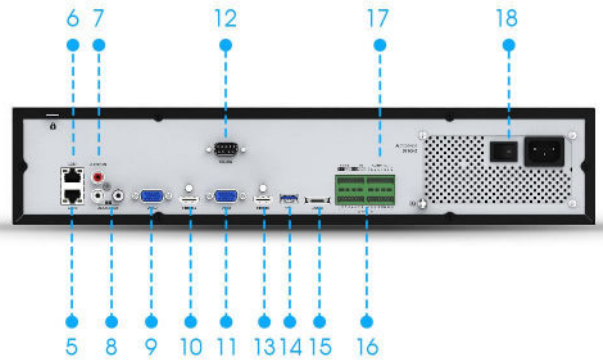
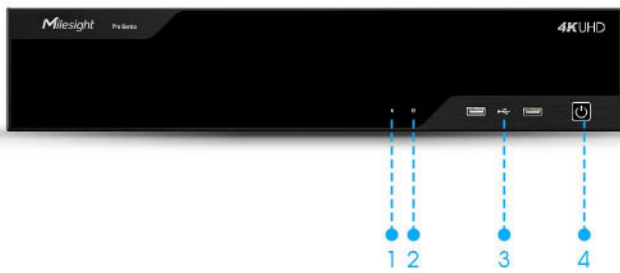

- 1. Run Indicator 2. HDD Indicator 3. USB 4. Power
- 5. LAN1 6. LAN2 7. Audio In 8. Audio Out
- 9. VGA2 10. HDMI2 11. VGA1 12. RS-232
- 13. HDMI1 14. USB 15. eSATA 16. Alarm In
- 17. Alarm Out 18. Power

Installation of HDDs



Step1



Step2



Step3



Step4



Step5

Structure Diagrams

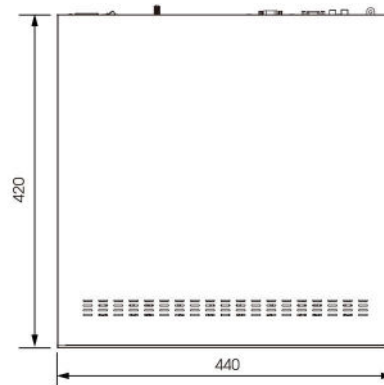

Units: mm

Naming Convention



Mlesight | www.mlesight.com

Contact Us: sales@mlesight.com support@mlesight.com

Add: 220 NE 51st Street, Oakland Park, Florida 33334, USA
Tel: +1-800-561-0485

Add: 925, Anyang SK V1 Center, LS-ro 116beon-gil, Dongan-gu, Anvang-si, Korea
Tel: +82-31-990-7732

Add: Building C09, Software Park Phase III, Xiamen 361024, Fujian, China
Tel: +86-592-5922772

